



Main Road | Brereton, Rugeley | WS15 1EB
Offers In The Region Of £275,000



Summary

**** DECEPTIVELY SPACIOUS BUNGALOW ** INTERNAL VIEWING IS ESSENTIAL ** THREE BEDROOMS ** FAMILY BATHROOM ** LOUNGE ** CONSERVATORY ** KITCHEN ** EXTENSIVE DRIVEWAY ** LANDSCAPED GARDENS ** GARAGE ****

WEBBS ESTATE AGENTS have pleasure in offering this spacious three-bedroom detached bungalow, located in the popular and well-connected area of Brereton, Rugeley, which offers an exciting opportunity for buyers looking to put their own stamp on a property. In need of some modernisation, the home presents great potential throughout. The property is ideally situated for local amenities, schools, transport links and within easy reach of Cannock Chase, an Area of Outstanding Natural Beauty. Briefly Comprising: Entrance Porch, Lounge, Kitchen, Three Bedrooms, Family Bathroom, Conservatory, Rear Garden Garage, Driveway. In summary, viewing is highly recommended to fully appreciate the space and potential this bungalow offers. Whether you're looking for a project, downsizing, or seeking a single-storey home in a well-regarded area, this property is a must-see.

Key Features

- NO UPWARD CHAIN
- THREE BEDROOMS
- CONSERVATORY
- DRIVEWAY FOR MULTIPLE VEHICLES
- POTENTIAL THROUGHOUT
- POPULAR LOCATION
- DETACHED
- GARAGE
- CLOSE TO AMENITIES
- SOUTH FACING GARDEN

Rooms and Dimensions

ENTRANCE PORCH

SPACIOUS LOUNGE

15'1" x 13'6" (4.60m x 4.14m)

INNER HALLWAY

KITCHEN

13'10" x 7'8" (4.22m x 2.34m)

BEDROOM ONE

14'7" x 9'11" (4.47m x 3.04m)

BEDROOM TWO

9'10" x 10'5" (3.01m x 3.19m)

CONSERVATORY

11'3" x 9'1" (3.44m x 2.79m)

BEDROOM THREE

9'4" x 6'5" (2.85m x 1.96m)

FAMILY BATHROOM

GARAGE

16'8" x 8'1" (5.10m x 2.47m)

LANDSCAPED REAR GARDEN

EXTENSIVE DRIVEWAY





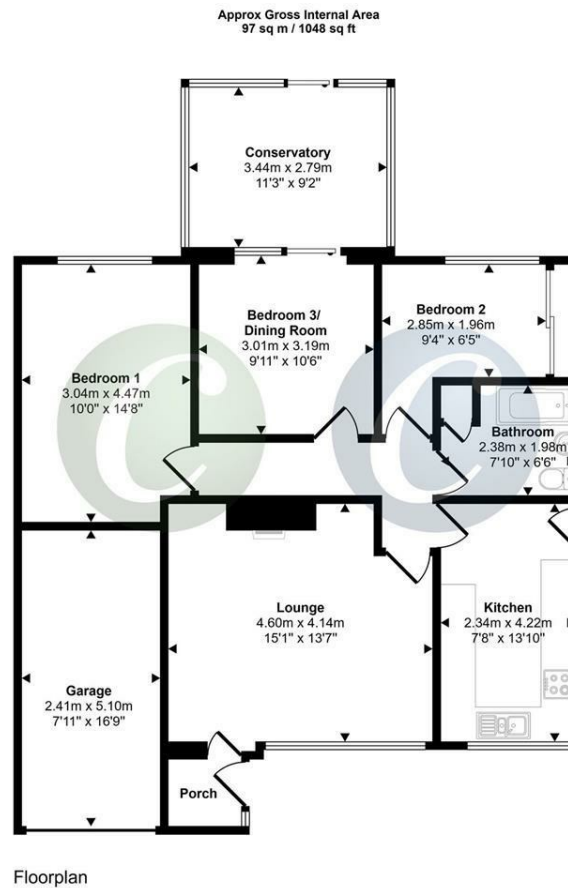

This floorplan is only for illustrative purposes and is not to scale. Measurements of rooms, doors, windows, and any items are approximate and no responsibility is taken for any error, omission or mis-statement. Icons of items such as bathroom suites are representations only and may not look like the real items. Made with Made Snappy 360.

Webbs Estate Agents - endeavour to maintain accurate depictions of properties in Virtual Tours, Floor Plans and descriptions, however, these are intended only as a guide and purchasers must satisfy themselves by personal inspection.

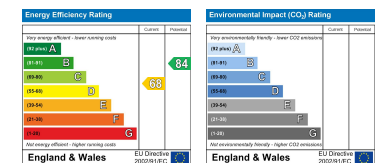

Globe House Upper Brook Street, Rugeley, Staffordshire, WS15 2DN

Tel: 01889 583377 | Email: rugeley@webbsea.co.uk | www.webbestateagents.co.uk

Webbs
estate agents